

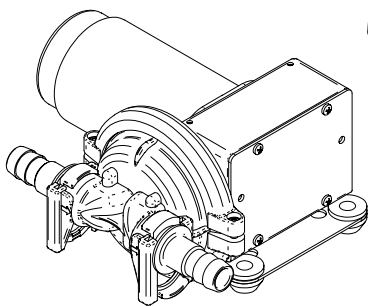
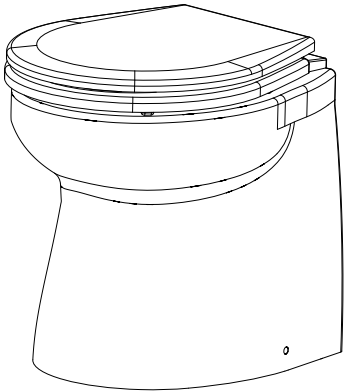

Photo: Jeanneau

Waste Water Handling & Marine Toilets

From a name you can trust, the AquaT™ toilet provides the comfort and convenience of a land-based lavatory at sea — a marine toilet that flushes as quietly as a toilet on land.

In combination with the Viking Power 16 or 32 and a Grey Water Tank you will have a complete waste water handling system.



Viking Power 16

A modern, single-chamber, self-priming diaphragm pump that can be set up in several different pump/motor configurations. It is easy to install anywhere after the drain outlet in the wastewater system or as a bilge pump in any leisure craft – new or used.

Its non-choke valves mean that no in-line filters are necessary. The pump can be run dry, and it can also handle a mixture of air and water without difficulty. The Viking Power 16 is self-priming up to a height of 3 meters.

With its low pulse and muffled rubber bracket, this pump offers quiet operation. Specifically designed to pump waste water, the Viking Power 16 has been built to last, and engineered for easy maintenance. When it comes time to replace the premium grade reinforced nitrile rubber diaphragm, you can put in a spare without even removing the pump from the system. Delivered with 1" hose and 3/4" hose 1/2" BSP KlickTite™ XL connectors. 90° KlickTite™ XL connectors available as extra accessory.



Viking Power 16

Motor	2.3 amp (12V), 1.2 amp (24V) at 0.1 bar 12/24V DC (with built-in thermal protection)
Body	Nylon, glass-fiber reinforced
Valves	Nitrile rubber
Diaphragm	Reinforced nitrile rubber
Length	186 mm – 7.3"
Width	235/181 mm – 9.3"/7.1"
Height	118/204 mm – 4.6/8"
Weight	2.6 kg – 5.7 lbs

Order No.	Description	Capacity, open flow	Capacity at 0.1 bar	Max lift	Max head	Connection
10-13350-03	Viking Power 16, 12V	16 l/min – 4.2 GPM	15 l/min – 4.0 GPM	3 m – 9.8 ft	3 m – 9.8 ft	KlickTite™ XL connectors for 1" hose or 3/4" hose and 1/2" BSP threads; straight and 90° (optional)
10-13350-04	Viking Power 16, 24V	16 l/min – 4.2 GPM	15 l/min – 4.0 GPM	3 m – 9.8 ft	3 m – 9.8 ft	

Grey Water Tank

The Grey Water Tank is designed to be used as collection tank for waste water from showers, sinks, dishwashing machines, etc with 19 mm, 25 mm and 38 mm inlet ports, and 19 mm and 25 mm outlet ports. The tank includes an Ultima Switch for automatic operation and is easy to connect to any 12V/24V pump up to 20 amp. The tank is prepared for Viking Power 16, with pre-drilled holes for the pump.



Dimensions 185x280x340 mm

Order No.	Description
09-13384	Grey Water Tank, excl. Viking Power 16

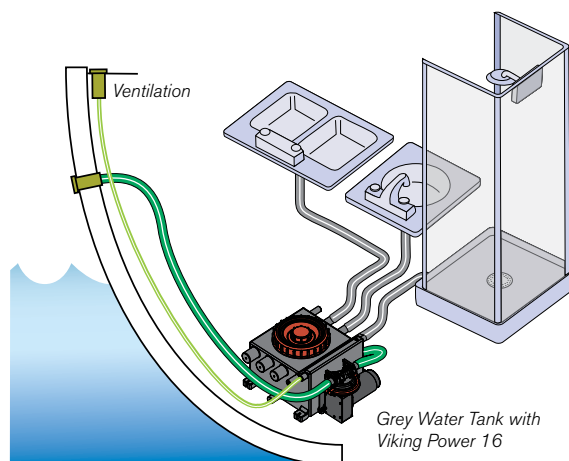

Viking Power 32 & Viking Power Vacuum

The Viking Power 32 and Viking Power Vacuum diaphragm pumps have been designed to meet the rigorous demands of the world's leading manufacturers of boats, recreational vehicles and busses.

Thanks to its single-chamber design and non-choke valves, the Viking Power 32, can be used to pump un-macerated sewage to a holding tank or transfer it onwards to a septic tank.

The Viking Power Vacuum has double check-valves and can therefore also be used in vacuum toilet systems. Naturally, pumping ordinary shower or sink drain water or bilge water is no problem for either pump.

Like the Viking Power 16, this pump has been engineered with a ball-bearing supported transmission for long service life. The pump cannot only be run dry, it can also handle a mixture of air and water without difficulty. The Viking Power 32/Vacuum provides maximum flow of 32 l/min and is self-priming up to a height of 2.5 m for VP 32 or 5 m for VP Vacuum. Although powered by an electric motor, this pump can also be cranked by hand in case of an emergency.

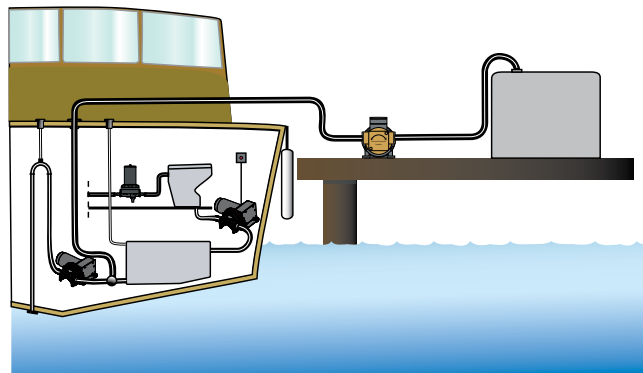

Viking Power 32

Motor	3.3 amp (12V), 1.6 amp (24V) at 0.1 bar 12/24V DC (with built-in thermal protection)
Body	Nylon
Valves	Nitrile rubber
Diaphragm	Reinforced nitrile rubber
Length	277 mm – 10.9"
Width	264 mm – 10.4"
Height	192 mm – 7.6"
Weight	5.0 kg – 11.0 lbs



Crank for manual handling

Order No.	Description	Capacity, open flow	Capacity at 0.1 bar	Max lift	Max head	Connection
10-13373-03	Viking Power 32, 12V	32 l/min – 8.5 GPM	30 l/min – 7.9 GPM	2.5 m – 8.2 ft	4 m – 13.1 ft	38 mm / 1½"
10-13373-04	Viking Power 32, 24V	32 l/min – 8.5 GPM	30 l/min – 7.9 GPM	2.5 m – 8.2 ft	4 m – 13.1 ft	38 mm / 1½"



Viking Power Vacuum

Motor	3.3 amp (12V), 1.6 amp (24V) at 0.1 bar 12/24V DC (with built-in thermal protection)
Body	Nylon
Valves	Nitrile rubber
Diaphragm	Reinforced nitrile rubber
Length	357 mm – 14"
Width	271 mm – 10.7"
Height	192 mm – 7.6"
Weight	5.1 kg – 11.2 lbs



Crank for manual handling

Order No.	Description	Capacity, open flow	Capacity at 0.1 bar	Max lift	Max head	Connection
10-13373-07	Viking Power Vacuum, 12V	24 l/min – 6.3 GPM	22 l/min – 5.8 GPM	5 m – 11.5 ft	4 m – 13.1 ft	38 mm / 1½"
10-13373-08	Viking Power Vacuum, 24V	24 l/min – 6.3 GPM	22 l/min – 5.8 GPM	5 m – 11.5 ft	4 m – 13.1 ft	38 mm / 1½"

Macerator Pump

The TA3P10-19 macerator pump takes care of toilet waste. A rotary cutter shreds waste before it is pumped into or out from the holding tank. The pump should be connected as close as possible to the holding tank discharge outlet or the bowl discharge outlet. Note! Use unbleached lavatory paper only.



TA3P10-19

Motor	2.3 amp (12V), 1.2 amp (24V) at 0.1 bar 12/24V DC (with built-in thermal protection)	Length	230 mm – 9.06"
Body	Phenol Plastic (PF)	Width	108 mm – 4.25"
Impeller	Nitrile	Height	82 mm – 3.23"
Housing	Thermoplastic Polyester (PET)	Weight	1.9 kg – 4.2 lbs
Shaft	Stainless Steel		
Seal	Lip Seal		

Order No.	Description	Capacity at 0.2 bar (6.7 ft)	Amperage	Fuze Size	Inlet Connection	Outlet Connection
10-24453-04	TA3P10-19, 12V	37 l/min – 10 GPM	15	20	1½" (dia 38 mm) hose or 1½"NPT	1" (25.4 mm) hose
10-24453-05	TA3P10-19, 24V	37 l/min – 10 GPM	9	10	1½" (dia 38 mm) hose or 1½"NPT	1" (25.4 mm) hose



AquaT™ Marine toilets

Available in a wide variety of different versions marketed under three basic models — standard and premium electric-powered or manual — the AquaT™ marine toilet has been designed to meet virtually every conceivable lavatory installation situation onboard.

Priced competitively, the fine finish and well thought-through design of these toilets is remarkable. Made from white vitreous porcelain, and with corrosion resistant parts throughout, the AquaT™ marine toilet, is quiet, robust and easy to clean.

Using the AquaT™ marine toilet, water inlet and outlet takes place in two distinct steps. First the bowl is filled with clear water, and then the waste is flushed, leaving the bowl empty and clean, with no liquids sloshing about. Naturally, automatic back-flow prevention is incorporated into the design.

Most models can be ordered with standard, bevelled or low profiles in order to fit almost any hull and bulkhead configuration, and all are available in either compact or comfort versions so you can outfit your marine lavatory with the perfect-sized toilet, no matter what the layout.

Power models are shipped with well-proven Aqua Jet diaphragm pumps in either 12V or 24V versions, and the manual version incorporates an ergonomically designed, hand-powered piston pump that can be mounted for either left-hand or right-hand use.

It is probably fair to think of most toilets as commonplace products, but look at the features and you are sure to see that the AquaT™ is far from ordinary. Quiet, hygienic and reliable, the AquaT™ marine toilet is perfect for almost any marine toilet room.

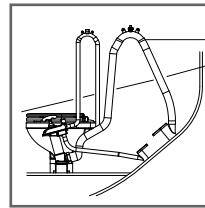

Toilet mounted below the waterline and discharging overboard.

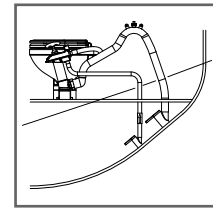

Toilet mounted above the waterline and discharging overboard.

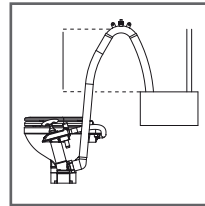

Toilet waste discharging into holding tank, discharging elbow below top of the holding tank at any time.

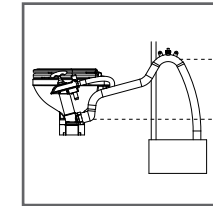

Toilet waste discharging into holding tank, discharging elbow always above top of the holding tank.



Manual Compact
80-47229-01



Manual Comfort
80-47230-01



Silent Electric Compact
80-47231-01, 12V
80-47231-02, 24V



Silent Electric Comfort
80-47232-01, 12V
80-47232-02, 24V



Std. Bidé
80-47317 Std. Bidé



Premium Low
80-47233-01, 12V
80-47233-02, 24V



Premium Low, Bevelled
80-47234-01, 12V
80-47234-02, 24V



Solenoid Low, Bevelled
80-47234-03, 12V
80-47234-04, 24V



Premium Std.
80-47235-01, 12V
80-47235-02, 24V



Premium Std. Bevelled
80-47236-01, 12V
80-47236-02, 24V

AquaT™ Manual

Order No.	Description	Net Weight	A	B	C	D	E	F
80-47229-01	Compact	9,6 kg 21 lbs	345 mm 13.6 inch	650 mm 25.6 inch	215 mm 8.5 inch	425 mm 16.7 inch	450 mm 17.7 inch	170 mm 6.7 inch
80-47230-01	Comfort	11 kg 24 lbs	340 mm 13.4 inch	705 mm 27.8 inch	275 mm 10.8 inch	490 mm 19.3 inch	470 mm 18.5 inch	185 mm 7.3 inch

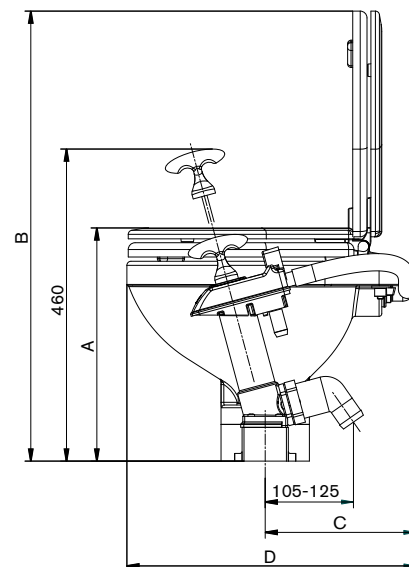
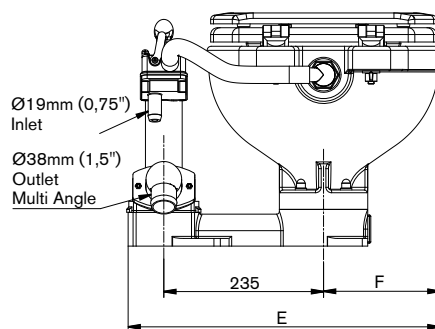
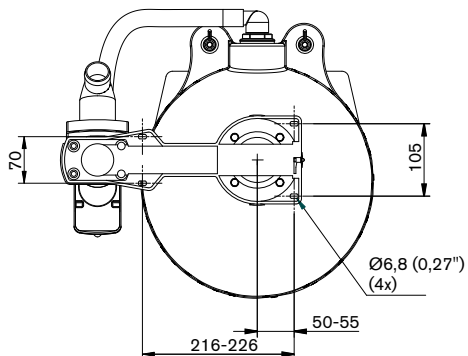

AquaT™ Silent Electric

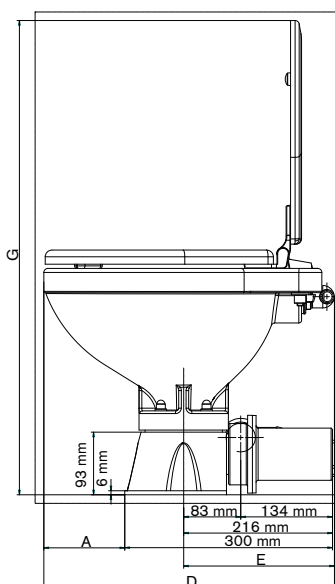
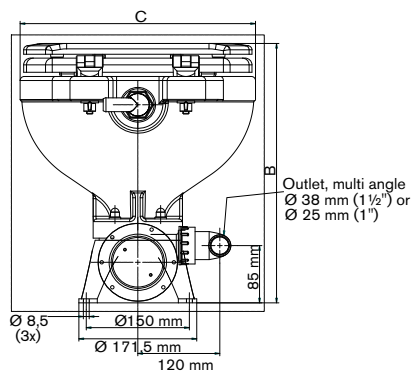

Order No.	Description	Net Weight	A	B	C	D	E	F	G
80-47231-01	Compact, 12V	9,6 kg 21 lbs	120 mm 4.7 inch	390 mm 15.4 inch	335 mm 13.2 inch	420 mm 16.5 inch	215 mm 8.5 inch	290 mm 11.4 inch	700 mm 27.6 inch
80-47231-02	Compact, 24V	9,6 kg 21 lbs	120 mm 4.7 inch	390 mm 15.4 inch	335 mm 13.2 inch	420 mm 16.5 inch	215 mm 8.5 inch	290 mm 11.4 inch	700 mm 27.6 inch
80-47232-01	Comfort, 12V	11 kg 24 lbs	190 mm 7.5 inch	385 mm 15.2 inch	365 mm 14.4 inch	490 mm 19.3 inch	275 mm 10.8 inch	280 mm 11.0 inch	755 mm 29.7 inch
80-47232-02	Comfort, 24V	11 kg 24 lbs	190 mm 7.5 inch	385 mm 15.2 inch	365 mm 14.4 inch	490 mm 19.3 inch	275 mm 10.8 inch	280 mm 11.0 inch	755 mm 29.7 inch

AquaT™ Premium

Order No.	Description
80-47233-01	Low, 12V
80-47233-02	Low, 24V
80-47234-01	Low, bevelled, 12V
80-47234-02	Low, bevelled, 24V
80-47234-03	Solenoid, Low, bevelled, 12V
80-47234-04	Solenoid, Low, bevelled, 24V
80-47235-01	Std., 12V
80-47235-02	Std., 24V
80-47236-01	Std. bevelled, 12V
80-47236-02	Std. bevelled, 24V

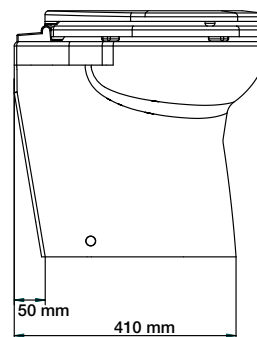
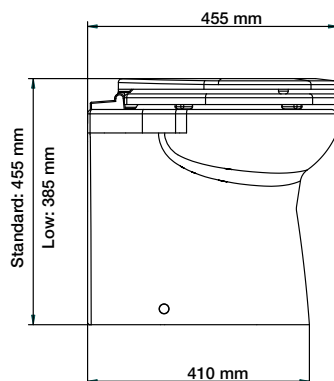
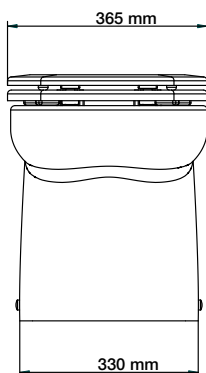

AquaT™ Bidet

Order No.	Description
80-47317	Std. Bidé

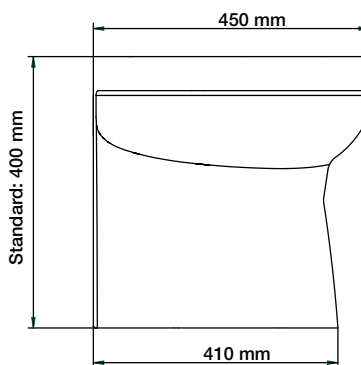
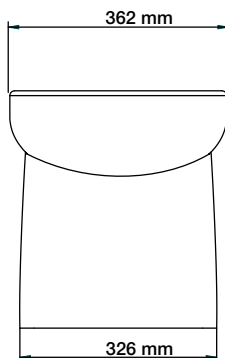

Accessories

Control Panel

Order No.	Description
81-36105-01	Control Panel, 12V & 24V



Viking Power 32

Order No.	Description
10-13373-03	Viking Power 32, 12V
10-13373-04	Viking Power 32, 24V



Vented Loop

Order No.	Description
81-47237-01	Vented Loop, 3/4"
81-47237-02	Vented Loop, 1"
81-47237-03	Vented Loop, 1.1/2"



Conversion Kit

Order No.	Description
81-47240-01	Conversion kit 12V
81-47240-02	Conversion kit 24V



Y-valve

Order No.	Description
81-47238-01	Y-valve



Solenoid

Order No.	Description
81-47301-01	Solenoid valve 12V
81-47301-02	Solenoid valve 24V



Flush 2.4 Pump

Order No.	Description
10-24677-01	Flush 2.4 Pump, 12V
10-24677-02	Flush 2.4 Pump, 24V

